

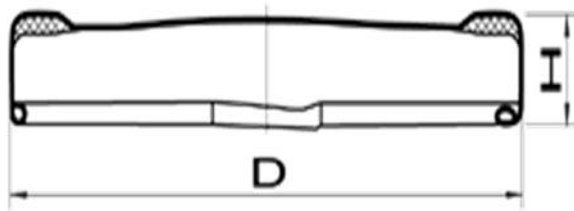

Профил / Profile RTO

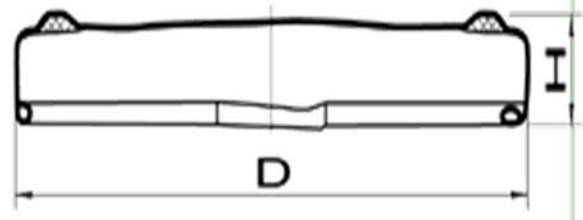

Профил / Profile RTS



## Screw caps

The caps are suitable to seal jars and bottles with screw caps thread. They can be used with any type of product with thermic treatment of pasteurization or sterilization (up to 131°C). The caps are made of:

- Tinplate according BS EN 10202:2001 externally colour lacquered or lithographed and internally lacquered with protective lacquer.
- The lacquers are in compliance with regulation 1935/2004 /EC; US FDA 21 CFR section 175.300 and have BFDGE certificates.
- There is a sealing ring from PVC plastisol in the inner side of the cap, according to European directive 2002/72/ EC from 6-th August 2002 regarding synthetic materials which come in contact with food; Directive 2005/79/EC from 18-th of November 2005 correction- 2002/72/EC; Directive 2007/19/EC from 2-nd April 2007 correction of 2002/72/EC; Directive 2008/39/EC from 6-th of April 2008 correction of 2002/72/EC.

The raw materials- tinplate, coating and sealing compound- are in compliance with European food treatment laws.

#

#

# Pilfer proof caps

ПП с уплътнител EPE  
PP with a gasket EPE

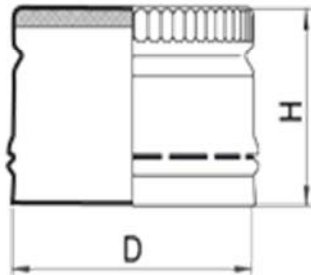

ПП с дозатор  
PP with a proportioner

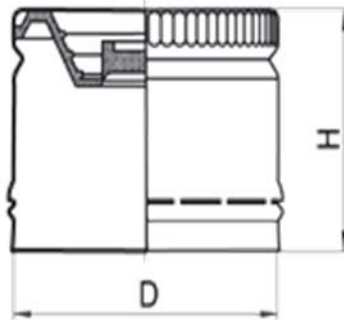

ПП с дозатор зехтин  
PP with an olive proportioner

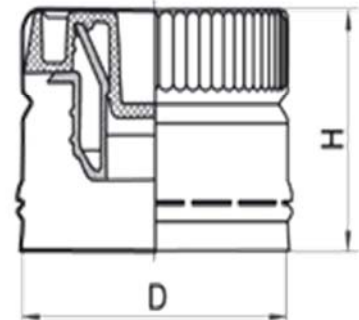

The caps are suitable to seal glass or plastic bottles of alcoholic or soft drinks as well as bottles of medicines. After opening the drop ring can be released. The caps are made of aluminium sheet externally colour lacquered or lithographed and internally lacquered with protective lacquer. There is a liner of high density expanded polyethylene on the inner side of the cap. The raw materials- aluminium sheet, coating and liner compound- are in compliance with European food treatment laws.

Размер Dimension	Диаметър Diameter D, mm	Височина Height H, mm	Вид уплътнителен елемент / Gasket		
			Пластизол PVC compound	EPE	Дозатор Proportioner
PP 25 x 17	25.6 ± 0.2	16.7	Ⓞ		
PP 28 x 16	28.3 ± 0.2	16.2	Ⓞ		
PP 28 x 17	28.3 ± 0.2	17.2		Ⓞ	
PP 28 x 18	28.3 ± 0.2	18.2		Ⓞ	
PP 31.5 x 18	31.5 ± 0.2	18.2		Ⓞ	Ⓞ
PP 31.5 x 24	31.5 ± 0.2	24.2		Ⓞ	Ⓞ

#  
#  
#  
#  
#

#

#

#